

Add Microsoft Authenticator to an existing account

- [Step 1](#)
- [Step 2](#)
- [Step 3](#)
- [Step 4](#)
- [Step 5](#)

Step 1

Head to <https://mysignins.microsoft.com/security-info>



Sign in

Email, phone, or Skype

No account? [Create one!](#)

[Can't access your account?](#)

Back

Next



← @southstatetech.com

Enter password

Password

[Forgot my password](#)

Sign in



@southstatetech.com

Enter code

 Enter the code displayed in the authenticator app on your mobile device

Code

[More information](#)

Step 2

On the Security Info page, click 'Add sign-in method', and then 'Microsoft Authenticator'

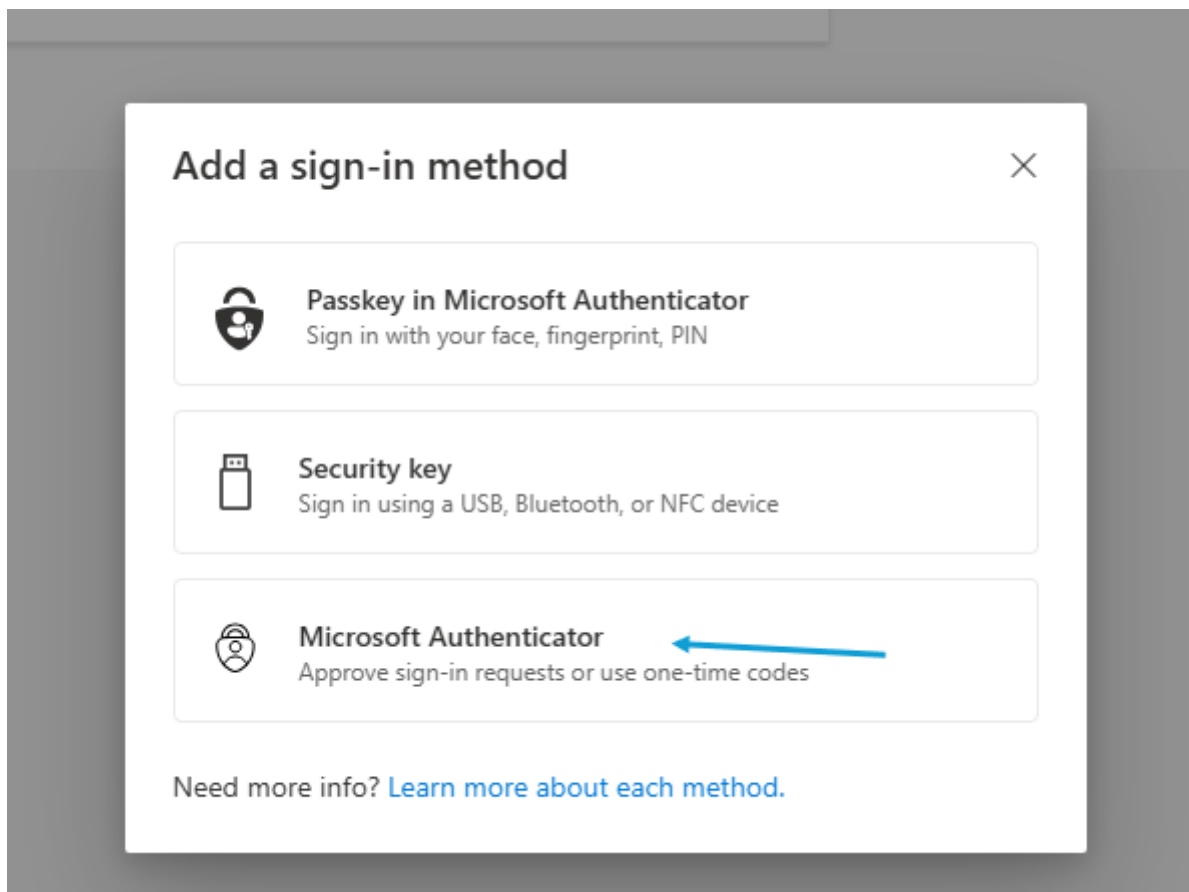
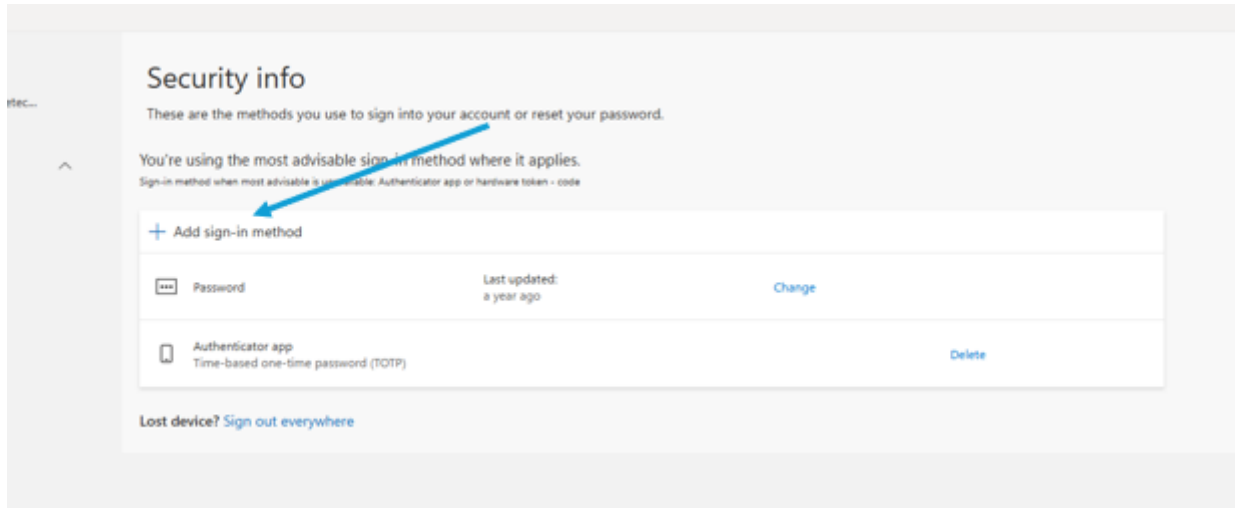

Step 3

Download the Microsoft Authenticator

For iOS iPhone and Android:

<https://kb.southstatetech.com/books/microsoft-authenticator>

Step 4

Scan the QR code with the Microsoft Authenticator

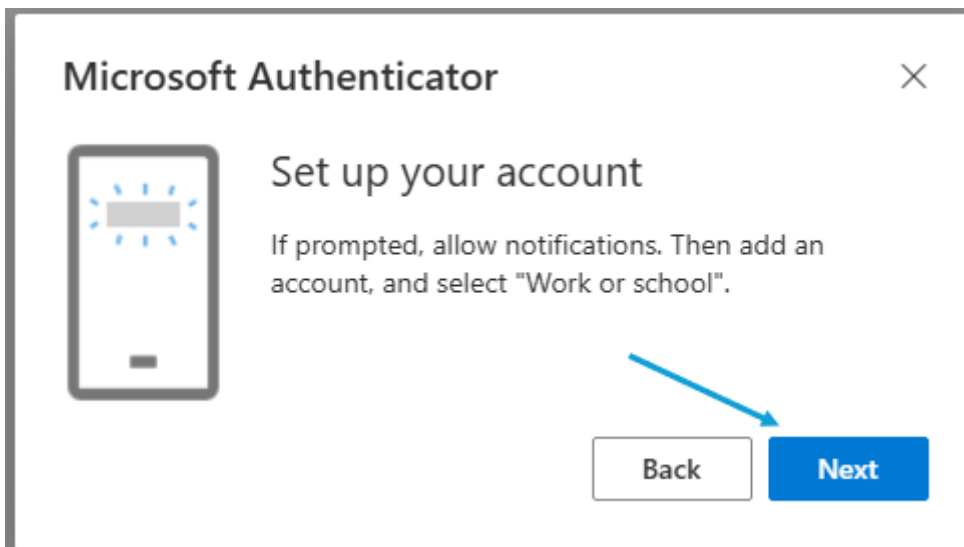
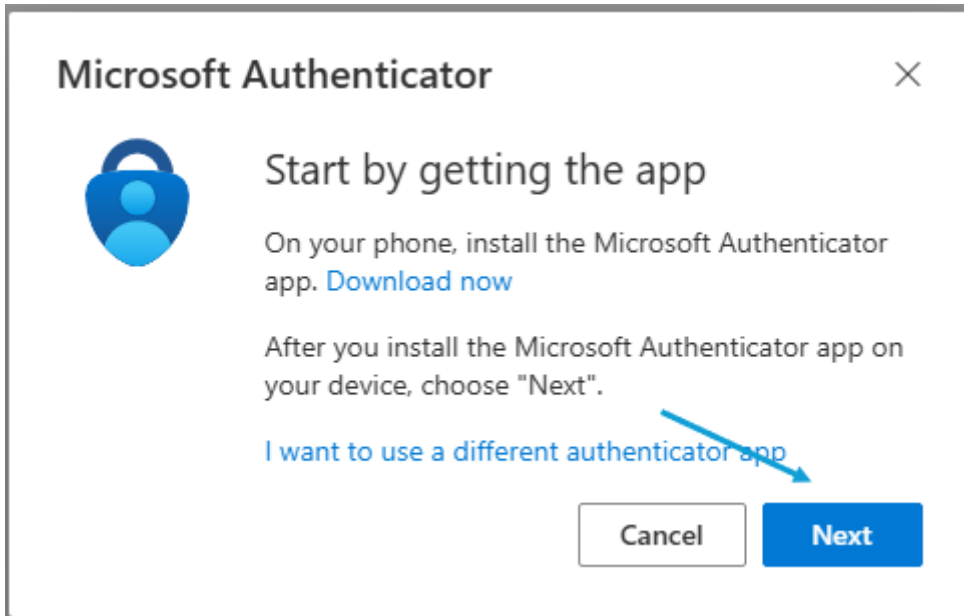

On the Authenticator App:

Skip



Secure Your Digital Life



Sign in with Microsoft

When you are signed in with Microsoft, all stored passwords, address, and other autofill info will be available on this device.



Add work or school account



Scan a QR code

Restore from backup

Microsoft Authenticator

Scan the QR code

Use the Microsoft Authenticator app to scan the QR code. This will connect the Microsoft Authenticator app with your account.

After you scan the QR code, choose "Next".



1

Can't scan image?

Back

Next

[I want to set up a different method](#)

2

Step 5

Use the Authenticator app to verify your account

Microsoft Authenticator

Let's try it out



Approve the notification we're sending to your app by entering the number

67

Back

[I want to set up a different method](#)

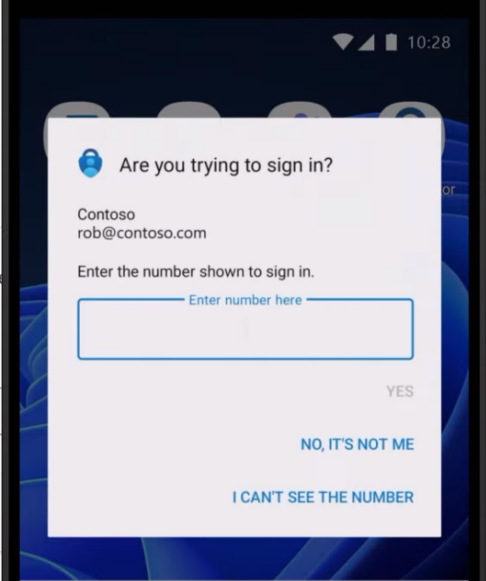

Microsoft Authenticator



✔ Notification approved

Back Next

[I want to set up a different method](#)

